

PRIMARY SCHOOL CONCEPTS

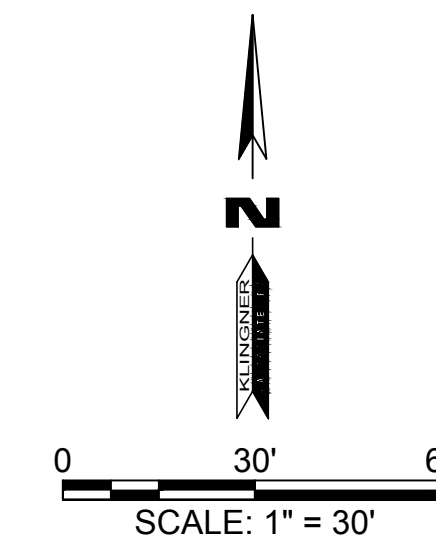

KLINGNER
& ASSOCIATES, P.C.
Engineers • Architects • Surveyors

Columbia, Missouri www.klingner.com
907 East Ash Street Quincy, IL, Galeburg, IL
573.355.5988 Hannibal, MO Burlington, IA Pella, IA



SAFEROOM CAPACITY: 220 STANDING
AND 2 WHEELCHAIR SPACES
BUILDING POPULATION: 520

ADDITION LEGEND

- EIGHT CLASSROOM 2ND GRADE ADDITION - \$2,620,000
- TWO CLASSROOM 1ST GRADE ADDITION - \$500,000
- TWO CLASSROOM KINDERGARTEN ADDITION - \$691,000
- GYMNASIUM ADDITION - \$2,634,000

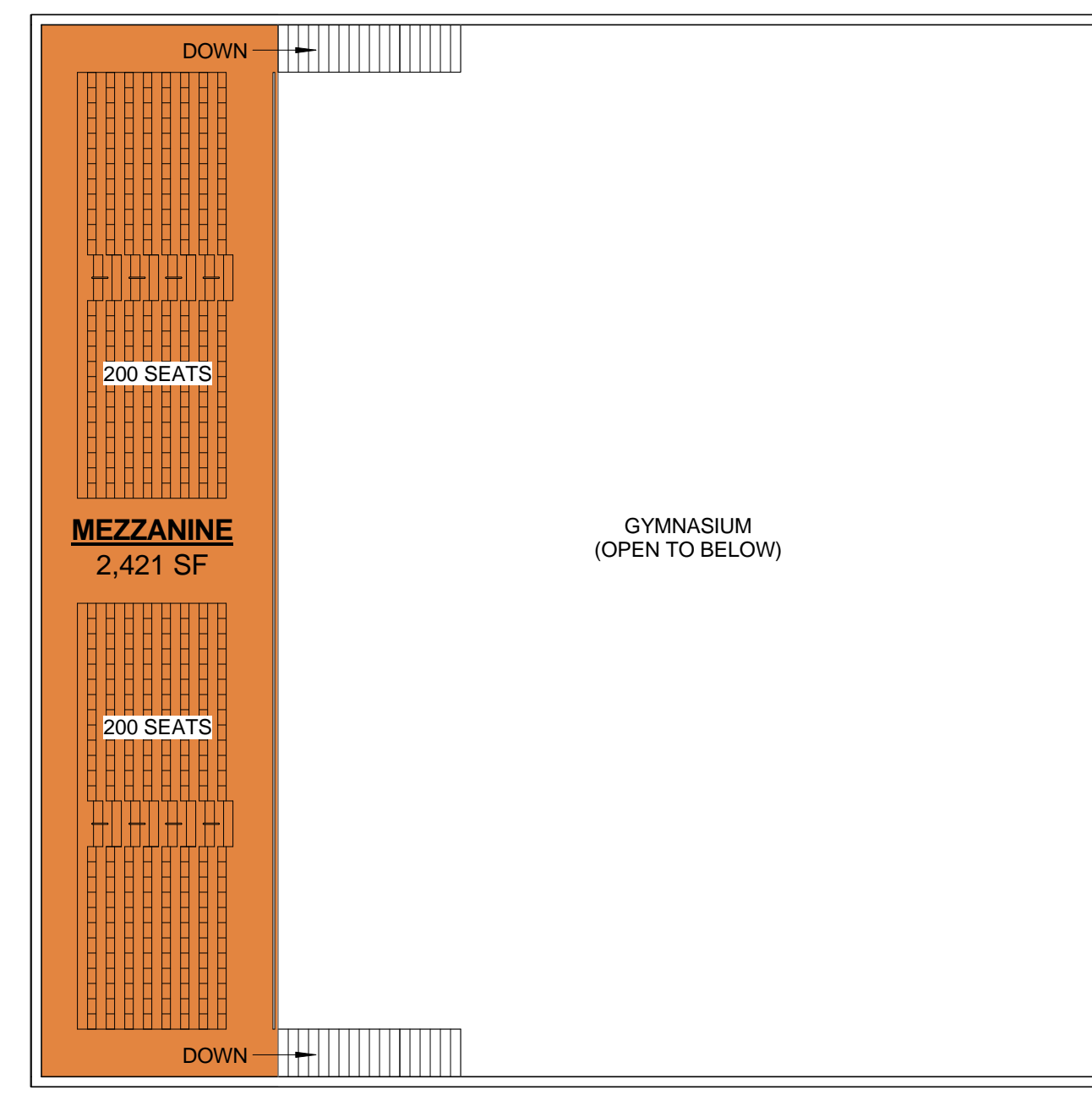

MEZZANINE PLAN



PRIMARY SCHOOL FLOOR PLAN: CONCEPT 'A'

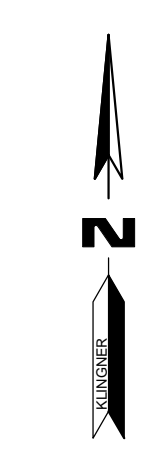

KLINGNER & ASSOCIATES, P.C.
Engineers • Architects • Surveyors

Columbia, Missouri
907 East Ash Street
573.355.5988

www.klingner.com
Quincy, IL, Gasleburg, IL
Hannibal, MO Burlington, IA, Pella, IA



SAFEROOM CAPACITY: 590 STANDING
AND 3 WHEELCHAIR SPACES
BUILDING POPULATION: 520

ADDITION LEGEND

■ EIGHT CLASSROOM 2ND GRADE ADDITION	- \$2,620,000
■ TWO CLASSROOM 1ST GRADE ADDITION	- \$575,000
■ TWO CLASSROOM KINDERGARTEN ADDITION	- \$690,000
■ GYMNASIUM ADDITION	- \$3,417,000

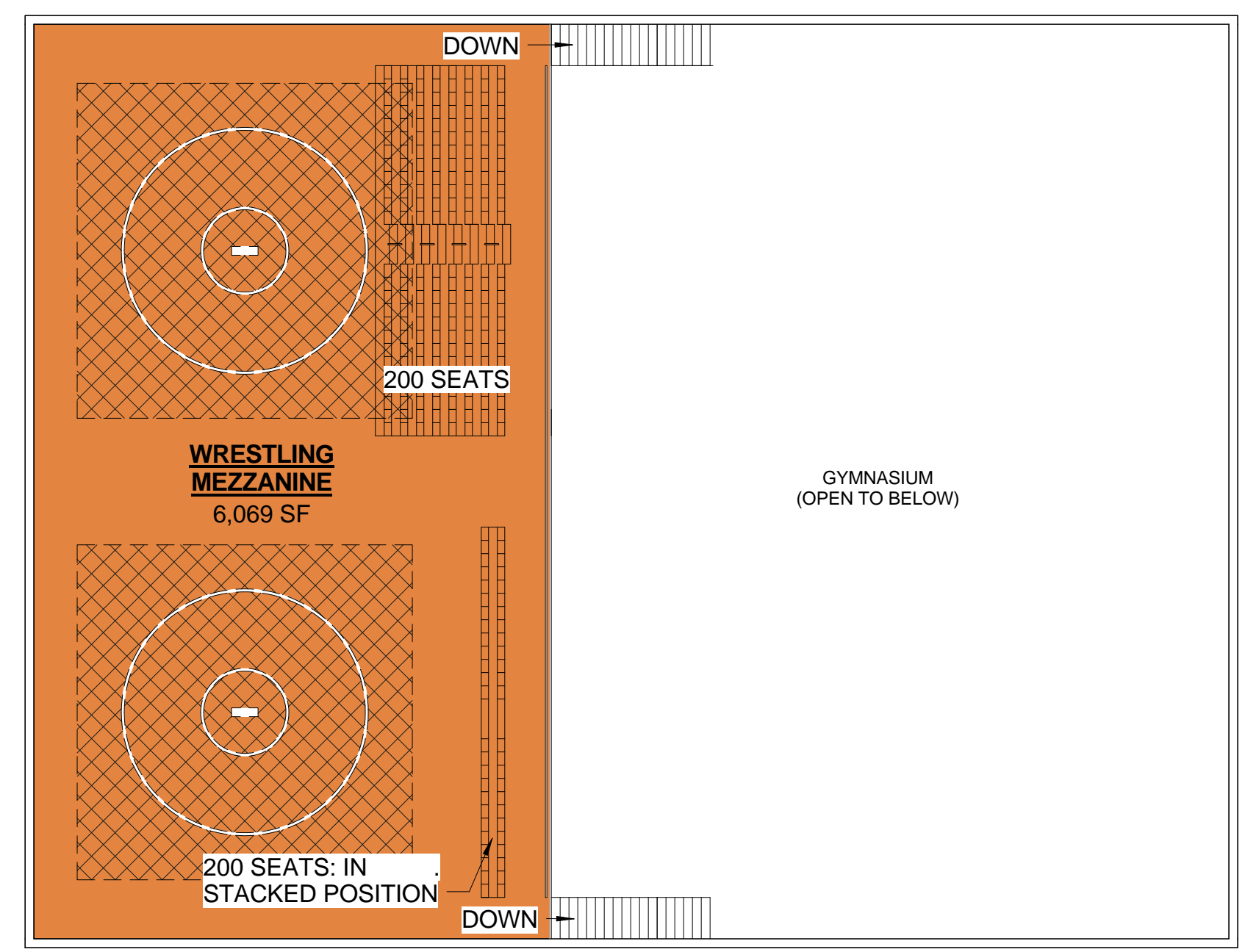

MEZZANINE PLAN - WRESTLING ROOM



PRIMARY SCHOOL FLOOR PLAN: CONCEPT 'B'



KLINGNER & ASSOCIATES, P.C.
Engineers • Architects • Surveyors

Columbia, Missouri
907 East Ash Street
573.355.5988

www.klingner.com
Quincy, IL, Galesburg, IL
Hannibal, MO Burlington, IA Pella, IA

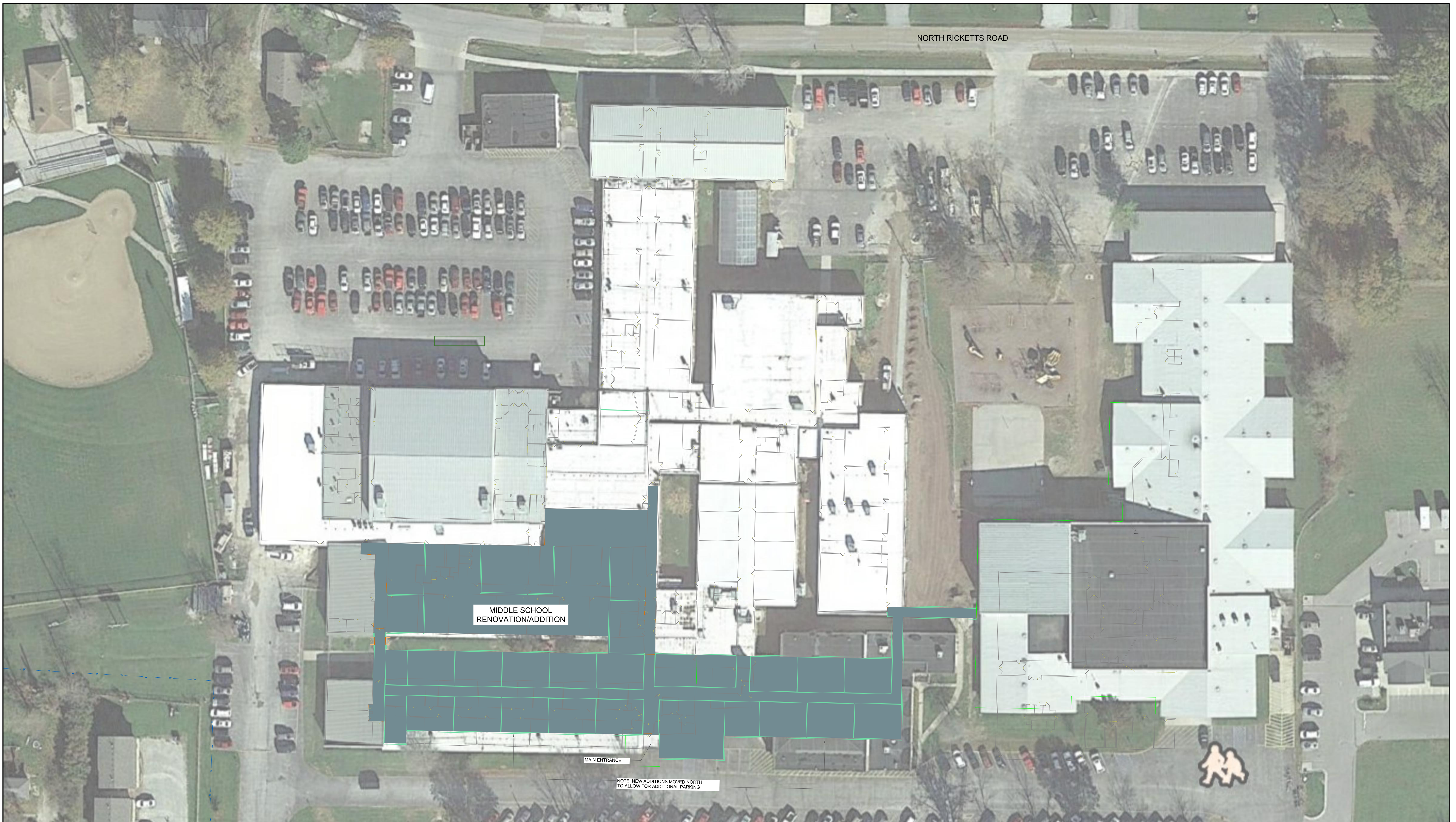

MIDDLE SCHOOL CONCEPTS

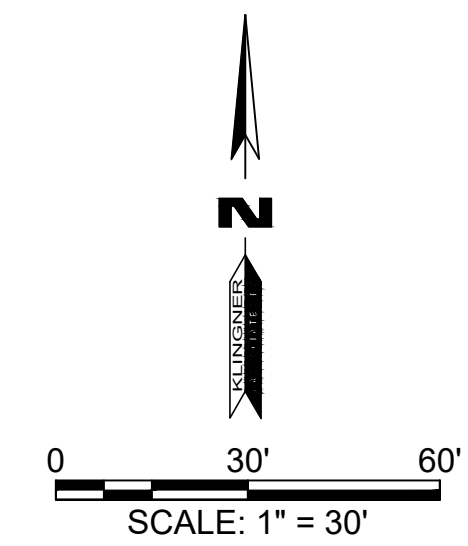

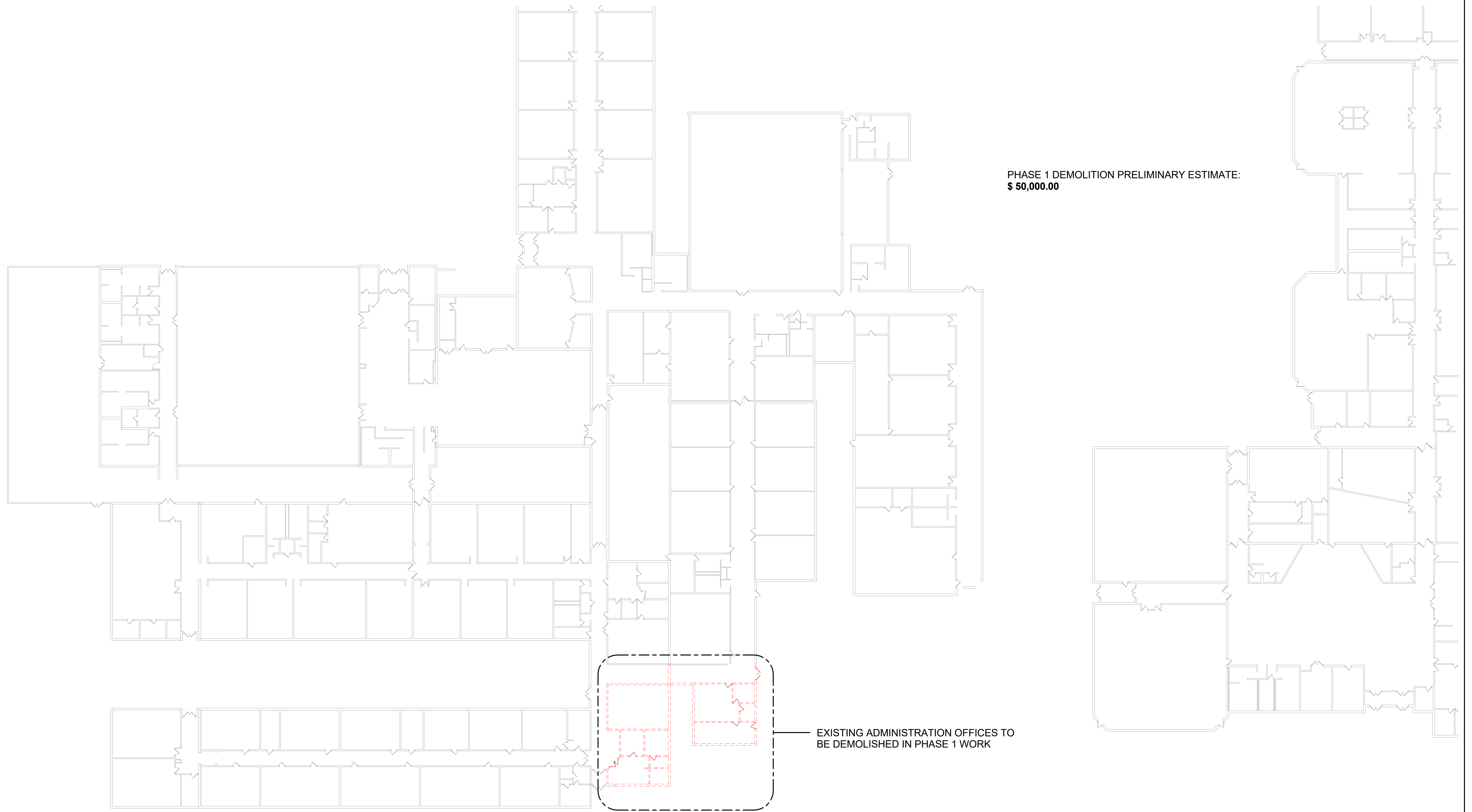

PHASE 1 DEMOLITION PRELIMINARY ESTIMATE:
\$ 50,000.00

EXISTING ADMINISTRATION OFFICES TO
 BE DEMOLISHED IN PHASE 1 WORK

DEMO FLOOR PLAN - PHASE 1
 3/64" = 1'-0"



MIDDLE SCHOOL FLOOR PLAN: PROPOSED PHASE 1 - DEMOLITION



KLINGNER
& ASSOCIATES, P.C.
 Engineers • Architects • Surveyors

Columbia, Missouri www.klingner.com
 907 East Ash Street Quincy, IL, Galesburg, IL
 573.355.5988 Hannibal, MO Burlington, IA Pella, IA

ROOMS ADDED:

- PHASE 1 - 6 CLASSROOMS
- PHASE 1 - 1 RESOURCE CENTER
- PHASE 1 - 1 MEDIA CENTER
- PHASE 1 - 1 ADMINISTRATION AREA

LEGEND

- PRIMARY CIRCULATION
- PHASE 1 - EAST WING ADDITION

PHASE 1: PRELIMINARY ESTIMATE:
\$ 3,772,000.00

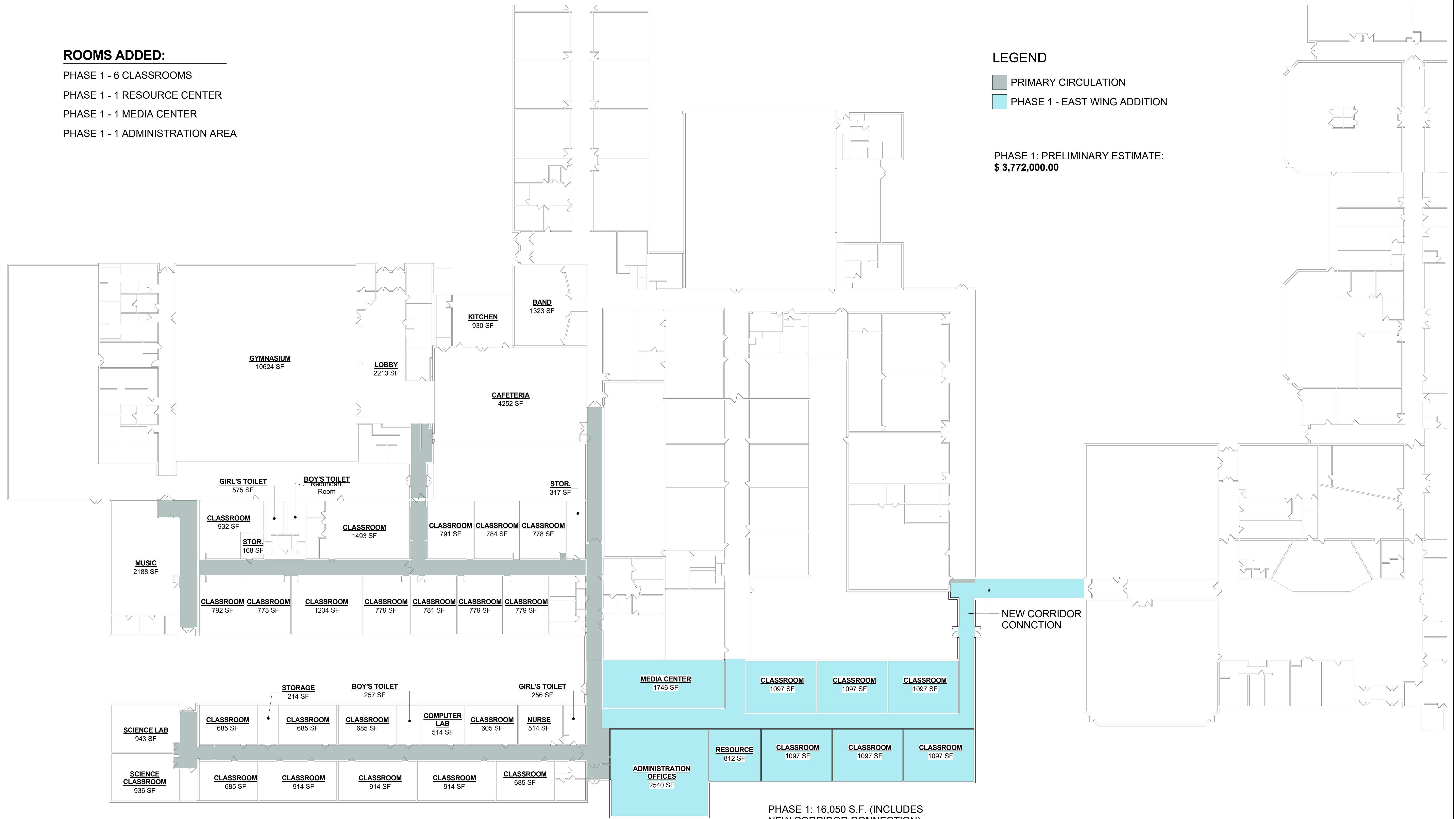

PHASE 1: 16,050 S.F. (INCLUDES
NEW CORRIDOR CONNECTION)

FLOOR PLAN - PHASE 1
3/64" = 1'-0"



MIDDLE SCHOOL FLOOR PLAN: PROPOSED PHASE 1



KLINGNER & ASSOCIATES, P.C.
Engineers • Architects • Surveyors

Columbia, Missouri
907 East Ash Street
573.355.5988

www.klingner.com
Quincy, IL, Galesburg, IL
Hannibal, MO, Burlington, IA, Pella, IA

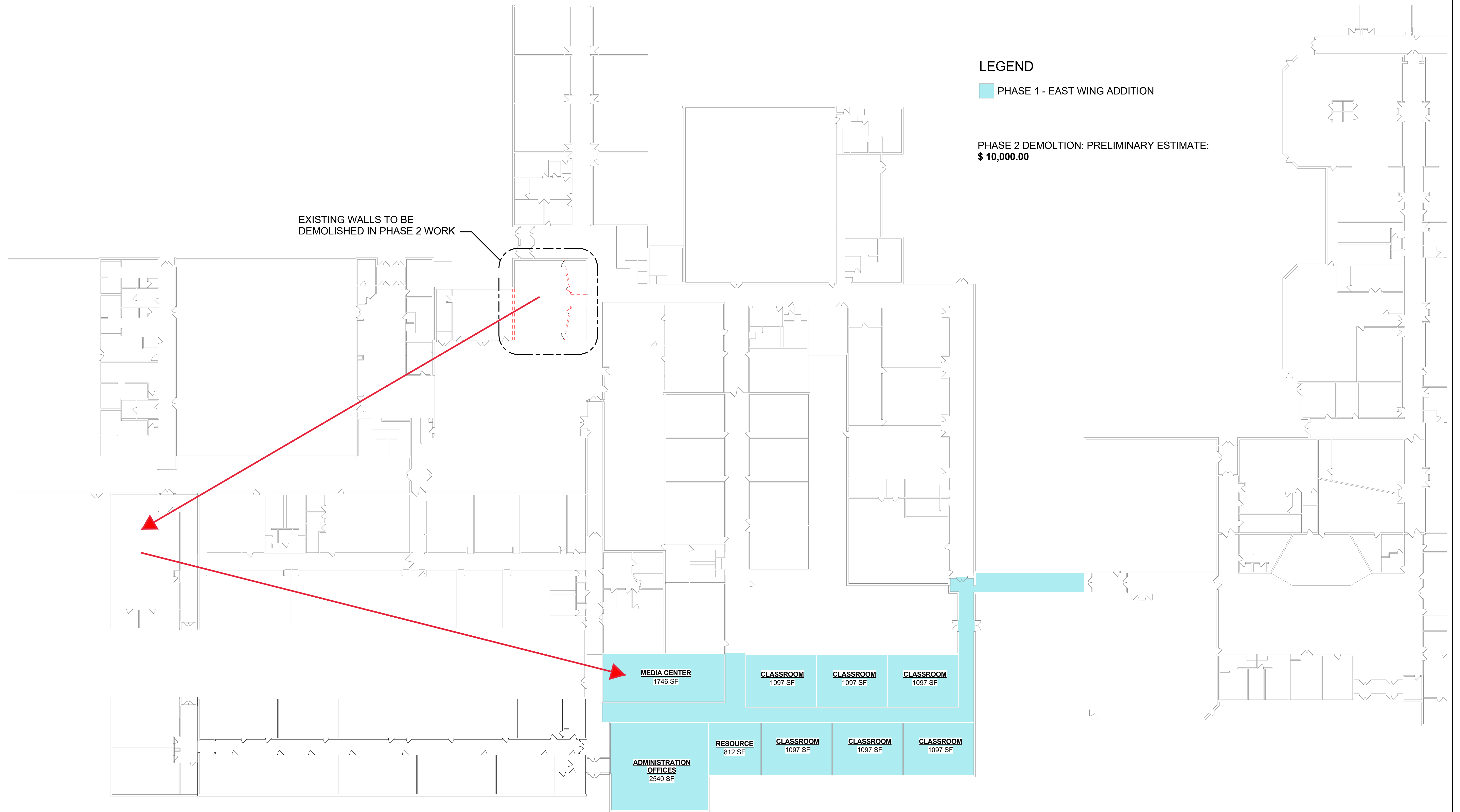

DEMOLITION FLOOR PLAN - PHASE 2
 3/64" = 1'-0"



MIDDLE SCHOOL FLOOR PLAN: PROPOSED PHASE 2 - DEMOLITION

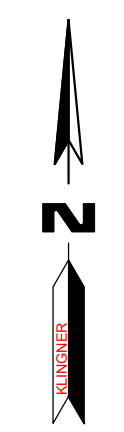

KLINGNER & ASSOCIATES, P.C.
 Engineers • Architects • Surveyors

Columbia, Missouri
 907 East Ash Street
 573.355.5988

www.klingner.com
 Quincy, IL, Galesburg, IL
 Hannibal, MO Burlington, IA Pella, IA

ROOMS ADDED:

PHASE 2 - CAFETERIA / KITCHEN EXPANSION

PHASE 1 - 6 CLASSROOMS

PHASE 1 - 1 RESOURCE CENTER

PHASE 1 - 1 MEDIA CENTER

PHASE 1 - 1 ADMINISTRATION AREA

LEGEND

- PRIMARY CIRCULATION
- PHASE 1 - EAST WING ADDITION
- PHASE 2 - CAFETERIA / KITCHEN EXPANSION

PHASE 1: PRELIMINARY ESTIMATE:
\$ 3,772,000.00

PHASE 2: PRELIMINARY ESTIMATE:
\$ 1,125,000.00

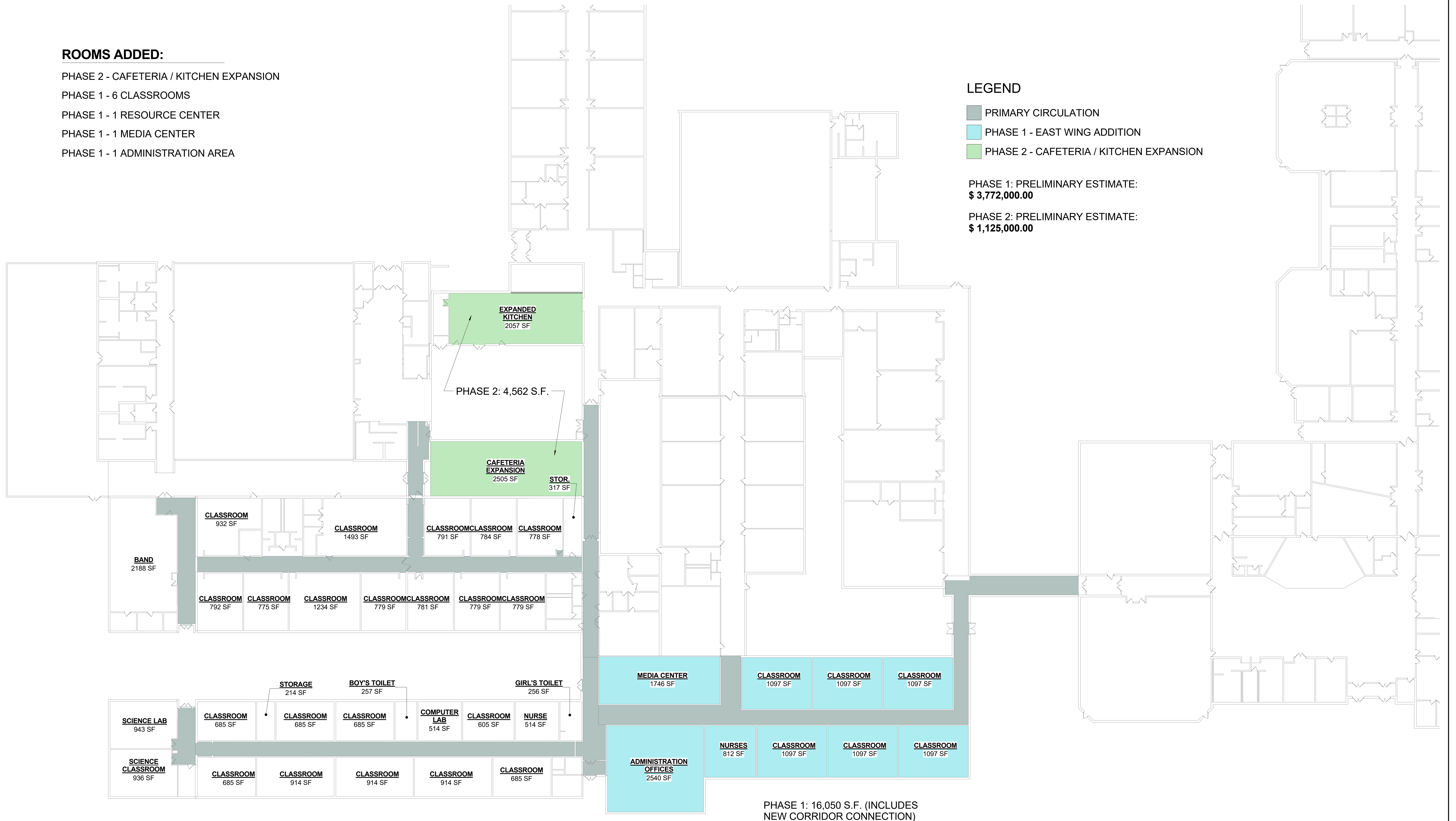

FLOOR PLAN - PHASE 2
3/64" = 1'-0"



MIDDLE SCHOOL FLOOR PLAN: PROPOSED PHASE 2



KLINGNER & ASSOCIATES, P.C.
Engineers • Architects • Surveyors

Columbia, Missouri
907 East Ash Street
573.355.5988

www.klingner.com
Quincy, IL, Galesburg, IL
Hannibal, MO Burlington, IA Pella, IA

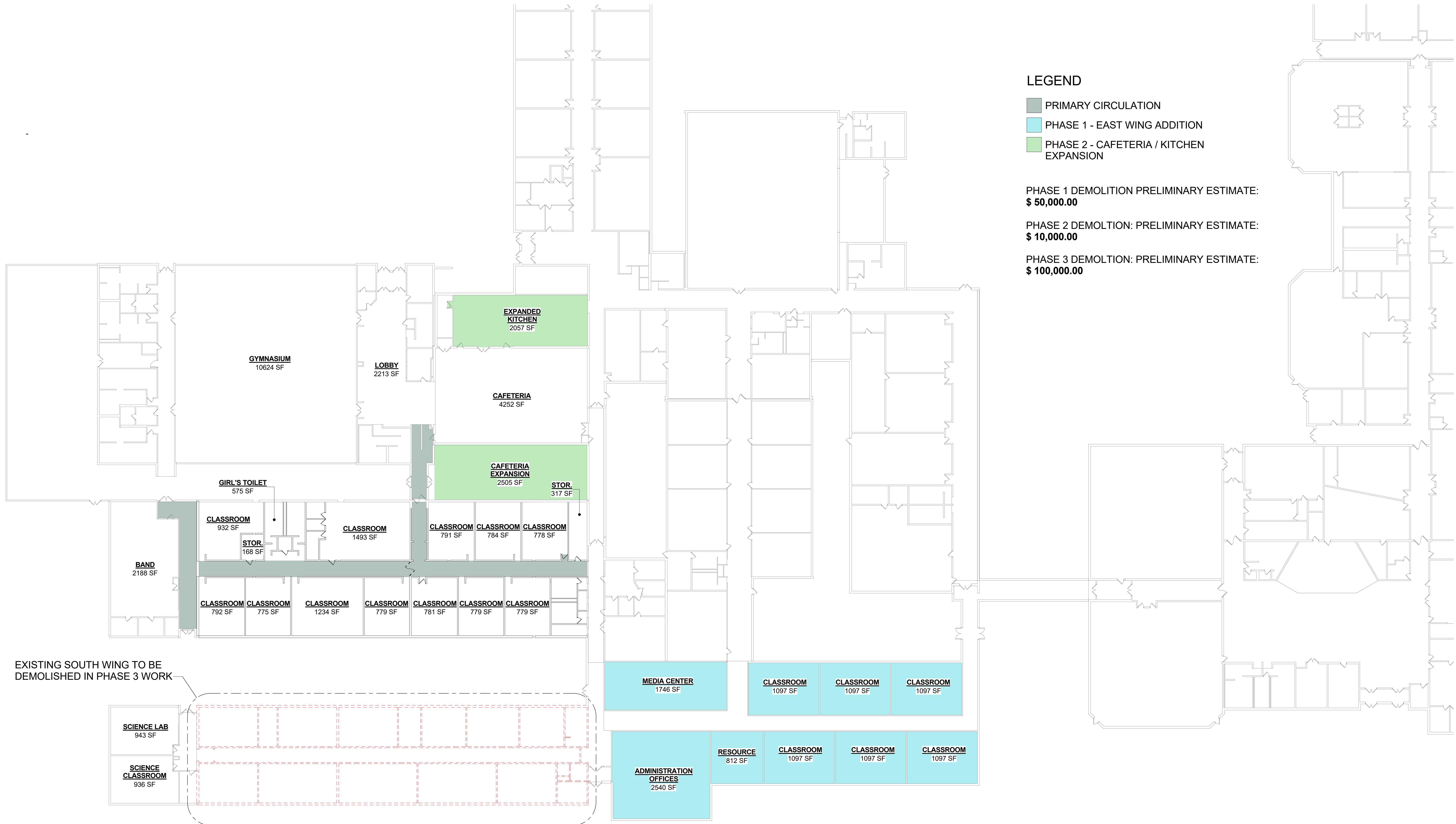

LEGEND

- PRIMARY CIRCULATION
- PHASE 1 - EAST WING ADDITION
- PHASE 2 - CAFETERIA / KITCHEN EXPANSION

PHASE 1 DEMOLITION PRELIMINARY ESTIMATE:
\$ 50,000.00

PHASE 2 DEMOLITION: PRELIMINARY ESTIMATE:
\$ 10,000.00

PHASE 3 DEMOLITION: PRELIMINARY ESTIMATE:
\$ 100,000.00

EXISTING SOUTH WING TO BE DEMOLISHED IN PHASE 3 WORK

DEMOLITION FLOOR PLAN - PHASE 3
 3/64" = 1'-0"



MIDDLE SCHOOL FLOOR PLAN: PROPOSED PHASE 3 - DEMOLITION

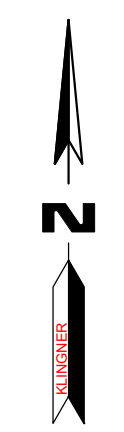

KLINGNER & ASSOCIATES, P.C.
 Engineers • Architects • Surveyors

Columbia, Missouri www.klingner.com
 907 East Ash Street Quincy, IL, Gasleburg, IL
 573.355.5988 Hannibal, MO Burlington, IA Pella, IA

ROOMS ADDED:

- PHASE 3 - 15 CLASSROOMS
- PHASE 2 - CAFETERIA / KITCHEN EXPANSION
- PHASE 1 - 1 RESOURCE ROOM
- PHASE 1 - 1 MEDIA CENTER
- PHASE 1 - 1 ADMINISTRATION AREA

ROOMS DEMOLISHED:

- PHASE 3 - 9 CLASSROOMS
- PHASE 3 - 1 RESOURCE ROOM
- PHASE 3 - 1 COMPUTER LAB

LEGEND

- PRIMARY CIRCULATION
- PHASE 1 - EAST WING ADDITION
- PHASE 2 - CAFETERIA / KITCHEN EXPANSION
- PHASE 3 - WEST WING ADDITION

PHASE 1: PRELIMINARY ESTIMATE:
\$ 3,772,000.00

PHASE 2: PRELIMINARY ESTIMATE:
\$ 1,125,000.00

PHASE 3: PRELIMINARY ESTIMATE:
\$ 3,466,000.00



FLOOR PLAN - PHASE 2
3/64" = 1'-0"

PHASE 1: 16,050 S.F. (INCLUDES NEW CORRIDOR CONNECTION)

PHASE 1: 16,050 S.F. (INCLUDES NEW CORRIDOR CONNECTION)



MIDDLE SCHOOL FLOOR PLAN: PROPOSED PHASE 3



LEGEND

- PRIMARY CIRCULATION
- PHASE 1 - EAST WING ADDITION
- PHASE 2 - CAFETERIA / KITCHEN EXPANSION
- PHASE 3 - WEST WING ADDITION

PHASE 1 DEMOLITION PRELIMINARY ESTIMATE:
\$ 50,000.00

PHASE 2 DEMOLITION: PRELIMINARY ESTIMATE:
\$ 10,000.00

PHASE 3 DEMOLITION: PRELIMINARY ESTIMATE:
\$ 100,000.00

PHASE 4 DEMOLITION: PRELIMINARY ESTIMATE:
\$ 100,000.00

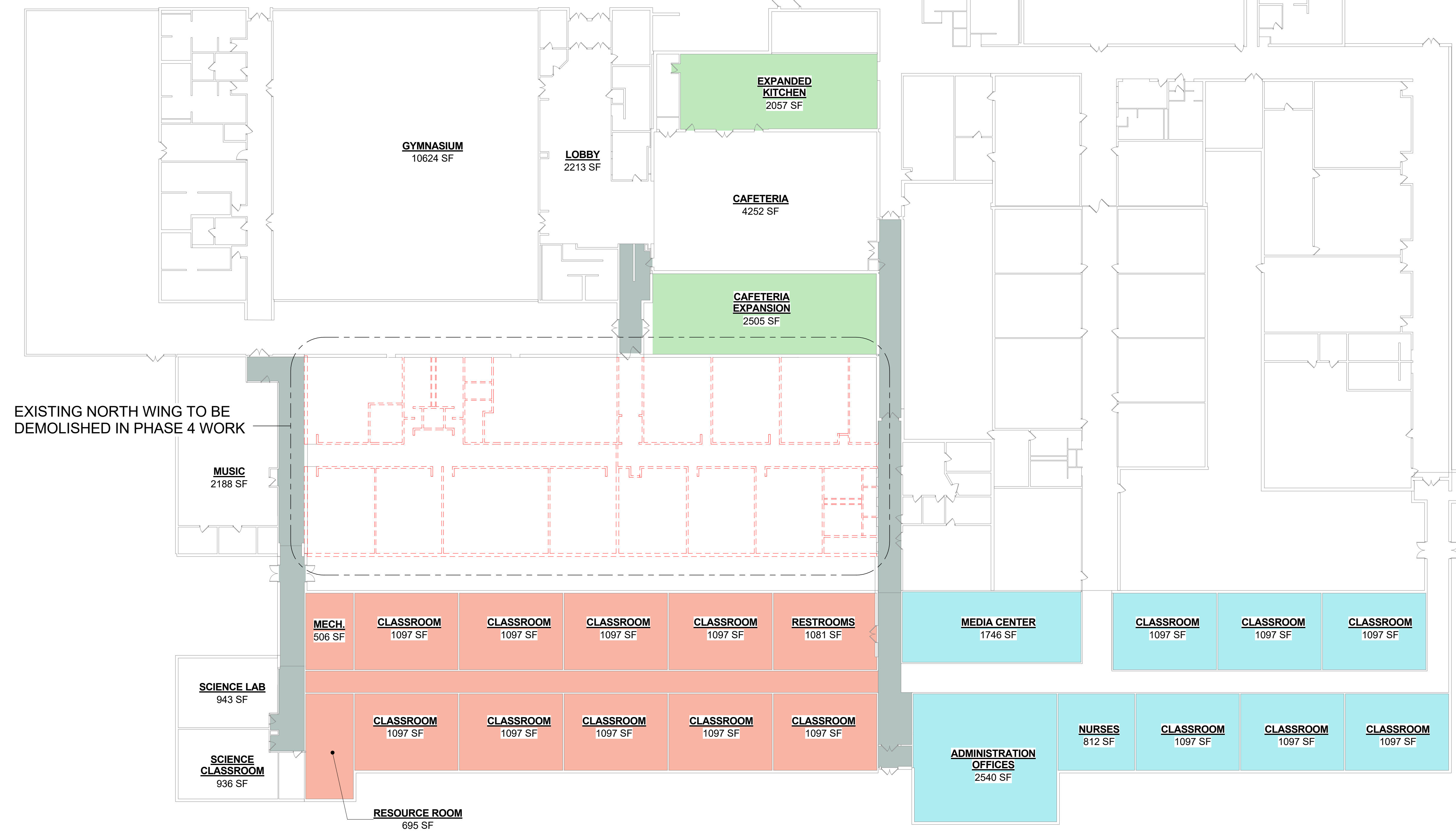

EXISTING NORTH WING TO BE DEMOLISHED IN PHASE 4 WORK

DEMOLITION FLOOR PLAN - PHASE 4
 3/64" = 1'-0"



MIDDLE SCHOOL FLOOR PLAN: PROPOSED PHASE 4 - DEMOLITION

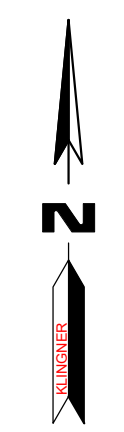

ROOMS ADDED:

- PHASES 1,3 & 4 - 19 CLASSROOMS
- PHASE 4 - 1 BAND ROOM
- PHASE 2 - CAFETERIA / KITCHEN EXPANSION
- PHASE 1 - 1 RESOURCE ROOM
- PHASE 1 - 1 MEDIA CENTER
- PHASE 1 - 1 ADMINISTRATION AREA

ROOMS DEMOLISHED:

- PHASES 3 & 4 - 21 CLASSROOMS
- PHASE 2 - 1 EXISTING BAND ROOM
- PHASE 3 - 1 RESOURCE ROOM
- PHASE 3 - 1 COMPUTER LAB

LEGEND

- PRIMARY CIRCULATION
- PHASE 1 - EAST WING ADDITION
- PHASE 2 - CAFETERIA / KITCHEN EXPANSION
- PHASE 3 - WEST WING ADDITION
- PHASE 4 - VARIOUS ROOMS

PHASE 1: PRELIMINARY ESTIMATE:
\$ 3,772,000.00

PHASE 2: PRELIMINARY ESTIMATE:
\$ 1,125,000.00

PHASE 3: PRELIMINARY ESTIMATE:
\$ 3,466,000.00

PHASE 4: PRELIMINARY ESTIMATE:
\$ 1,620,000.00

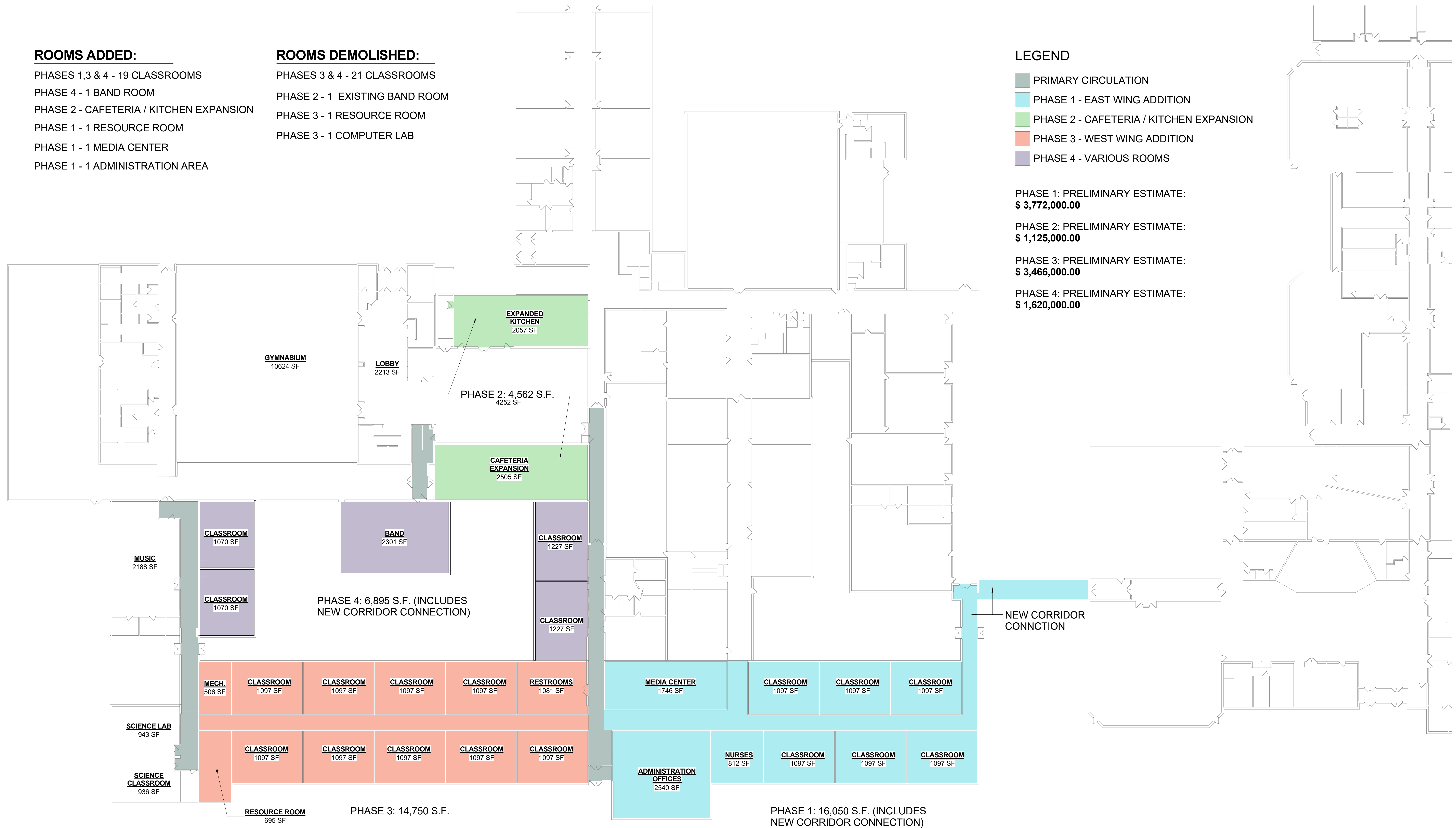

FLOOR PLAN - PHASE 4
3/64" = 1'-0"



MIDDLE SCHOOL FLOOR PLAN: PROPOSED PHASE 4



KLINGNER & ASSOCIATES, P.C.
Engineers • Architects • Surveyors

Columbia, Missouri www.klingner.com
907 East Ash Street Quincy, IL, Galesburg, IL
573.355.5988 Hannibal, MO Burlington, IA Pella, IA